

## D6575

### Digital Audio Processor



#### Description

D6575 digital audio processor is fully digital, automatic, intelligent and full-featured. It is specially designed for audio enhancement equipment in digital conference system engineering, professional sound system engineering and other advanced entertainment places.

#### Features

- With 96KHz sampling frequency, 32-bit DSP processor, 24-bit A/D and D/A converter.
- With 4 audio signal inputs, 3 groups of 5 mic inputs, standard 3.1, 4 or 5.1 channel output.
- With a USB interface to connect a PC, with remote control and infrared control.
- The function keys or thumb wheel on the panel or PC control software can be used directly for function settings, which is convenient, intuitive and simple.
- A single machine provides 20 groups of device data storage and 10 groups of effect data storage, which can be copied between devices through PC software.
- It can be locked by functions to realize data confidentiality, so as to prevent the operation of miscellaneous personnel from damaging the working state of the machine.
- Each output channel has a 7-band independent EQ (optional parameters, high key and low key), a high-pass filter and a low-pass filter. Both the high-pass filter and the low-pass filter have 1 slope and 3 different modes.
- Adopt Chinese character LCD screen and 6-segment LED to display accurate digital level meter, mute and editing status of the input/output channel.
- Each input and output has delay, phase control and mute settings, with the input delay up to 30ms and the output delay up to 60 ms.
- The effect ratio, microphone volume, music volume and effect volume of the output channel can be controlled.
- The microphone has 4 levels of anti-howling function, and both microphone and music signal have noise gates.
- The effect has 3-band parametric equalization and a pair of high-pass and low-pass filters, and the specific parameters of echo and effect are adjustable.
- The main parameters of the channel can be controlled by connecting the central control through the S terminal or USB interface.
- It can be connected to a PC via WIFI and can be remotely controlled via the Internet.
- With a resolution of  $\geq 1279 \times 790$ .

# Specifications

Model	D6575
Output Channel Jacks	5.1 XLR male (a pair of main channel, a pair of surround, center, sub) and optical fiber output
Input Channel Jacks	1 in 4 music signal (RCA input, optional fiber input, coaxial input), 5 in three groups mic input hole
Input Impedance	Unbalance: 20K $\Omega$
Output Impedance	Balance: 100 $\Omega$
PC Port	1 USB (front panel)
Remote Control	S terminal
CMRR	>70dB(1KHz)
Input Range	$\leq$ +5dBu
Frequency Response	20Hz-20KHz(-0.5dB)
S/N R	$\geq$ 95dB@1KHz 0dBu
THD	<0.03%OUTPUT=0dBu/1KHz
Crosstalk of Channels	>110dB(1KHz)
<b>Functions of Input Channels</b>	
Input Mute	Each channel has independent mute control.
Input Delay	Each input channel has a separate delay control, adjustable range of 0-30ms, less than 10ms, step away from the 0.1ms; greater than 10ms, step away from the 1ms
Input Polarity	+/-
Input Select	MUSIC AUX/VOD/Coaxial/Optical, AUX/VOD can select 0dB or 6dB
Input EQ	Set a 9-band EQ for Music and MIC (EQ1 low, EQ9 high, others with PEQ): center frequency: 20Hz-20KHz, bandwidth: 0.01oct-3oct, with a step size of 0.01oct, gain: -30dB-+15dB, with a step size of 0.1dB, default frequency: EQ1 40Hz, EQ2 80Hz, EQ3 160Hz, EQ4 317Hz, EQ5 632Hz, EQ6 1261Hz, EQ7 2515Hz, EQ8 5018Hz, EQ9 10KHz. In addition to the 9-band EQ, additional high-pass and low-pass filters with fixed slopes are added.
Input Volume	Each input volume range: 0-100%, step@1%
Limiter	Each input channel has a limiter. Threshold: -30dBu~+20dBu step: 0.1dBu
Feedback	4 level
<b>Functions of Output Channels</b>	
Output Mute	Each channel has independent mute control.
Output Polarity	In-phase (+/+) or reversed phase (+/-)
Output EQ	Set a 7-band EQ for each output channel (low, high, PEQ): center frequency: 20Hz-20KHz, bandwidth: 0.01oct-3oct, with a step size of 0.01oct, gain: -30dB-+15dB, with a step size of 0.1dB, default frequency: EQ1 47Hz, EQ2 112Hz, EQ3 266Hz, EQ4 631Hz, EQ5 1495Hz, EQ6 3544Hz, EQ7 8399Hz.
Output Gain	Each output volume range: 0-100%, step@1%
Output Delay	Each output channel has a separate delay control, adjustable range of 0-60ms, less than 10ms, step away from the 0.1ms; greater than 10ms, step away from the 1ms
X-OVER	Each output channel can be independently set as LPF or HPF. These parameters can be adjusted. Filter type: Linkwitz-Riley; Bessel; Butterworth. The crossover frequency: 20Hz~20KHz, slope: 12db/oct; 18db/oct; 24db/oct;

		30db/oct; 36db/oct; 42db/oct; 48db/oct.
Limiter		Each output channel has a limiter, threshold: -30dBu~+20dBu step: 0.1dBu
Effect		3 band of EQ, HC/LC, effect ratio can be adjusted
Processor		96KHz sampling frequency, 32-bit floating-point DSP, 24-bit A/D and D/A conversion
Display		The distinguishing rate for 144*32 characters LCD screen
Power		≤30W
Power Supply		AC110V/220V 50/60Hz
Product Dimensions (W×D×H)		482×228×44mm
Net Weight		4.5kg
Shipping Dimensions (W×D×H)		1PC: 555×325×98mm/0.0177m <sup>3</sup> 6PCS: 573×337×615mm/0.1188m <sup>3</sup>
Gross Weight		1PC: 5(kg) 6PCS: 31.5(kg)

## Front / Rear Panel

### Front Panel

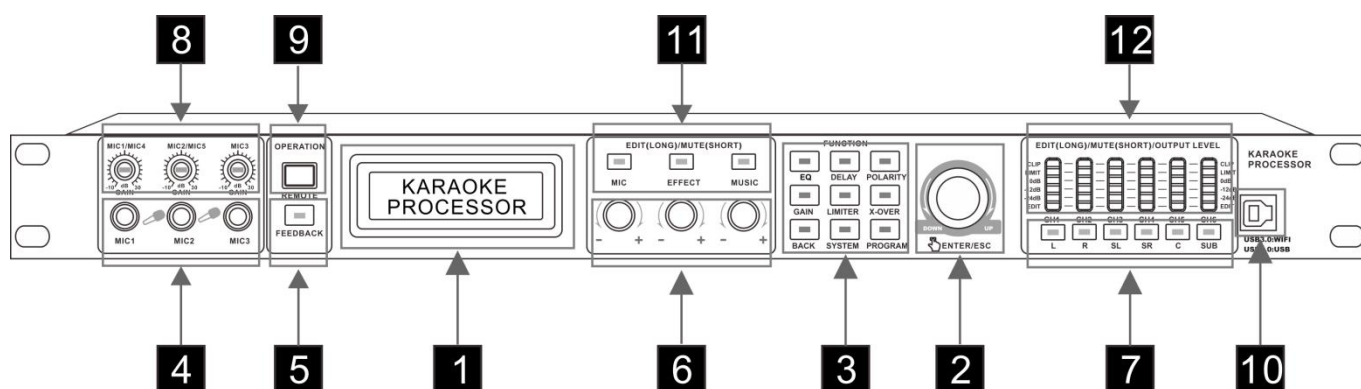

#### 1 LCD display

LCD Screen, display operation interface and information of each menu.

#### 2 Encoder

- (1) Turn clockwise: The parameter increases / next option
- (2) Turn counter-clockwise: The parameter decreases / previous option
- (3) Short press: [ok] button
- (4) Long press: special confirmation

#### 3 The menu information

- (1) **【EQ】**      (2) **【DELAY】**      (3) **【POLARITY】**  
 (4) **【GAIN】**    (5) **【LIMITER】**    (6) **【X-OVER】**  
 (7) **【BACK】**    (8) **【SYSTEM】**    (9) **【PROGRAM】**

Under the parameters edit state, press (1)(2)(3)(4)(5)(6) will enter into the corresponding menu.

Under any state , press (7) will return or cancel the operation

Under any state, press(8) (9) will enter into the system menu

#### **4** Microphone socket

Have three groups microphone socket with switch on the front panel, the priority is higher than Rear Panel's .

#### **5** Feedback control key

This key have 5 states, when closed,the light is turn off, when from level 1 to 4,the light is in yellow.

To switch the states ,just press the key.

#### **6** Microphone, Effect And music volume knob

Rotate knob to change the volume

#### **7** Output mute, Edit keys

Press **【OUT 1】** , **【OUT 2】** , . . . **【OUT 6】** mute/edit

Short–touch press: Mute/Unmute Switch,the key's light is in red.

Long–touch press:when access Output editing function interface, the EDIT indicator light is turn on.

#### **8** Microphone socket

Have three groups microphone socket with switch on the front panel,the priority is higher than Rear Panel's .

#### **9** Infrared receiving window

Equiped with remote control operation throuth remote controller, the detail please refer the part of "Remote control Function introduction".

#### **10** USB port

Adjusting the relative parameter through PC interface software  
( Compatible USB2.0,USB3.0 )

Through USB 3.0 cable connection wifi module, which can control the network connection, the remote control of the Internet

#### **11** Input mute, Edit keys

**【MIC】** , **【EFFECT】** , **【MUSIC】** mute/edit

Short–touch press: Mute/Unmute Switch,the key's light is in red.

Long–touch press:when access Output editing function interface, the EDIT indicator light is turn on.

#### **12** Output indicator light

The LED meter shows the input figure with 6 segments and editing status

(1) CLIP (clip) show, the light will be open (RED)when signal distort

(2) Limit show ,the light turn to be orange

(3)COMP show , the light turn to be yellow

(4) -24 dB -0dB two section LED meter show ( Green)

(5) Edit:When the light is in yellow, showing which channel are being edit.

## Rear Panel

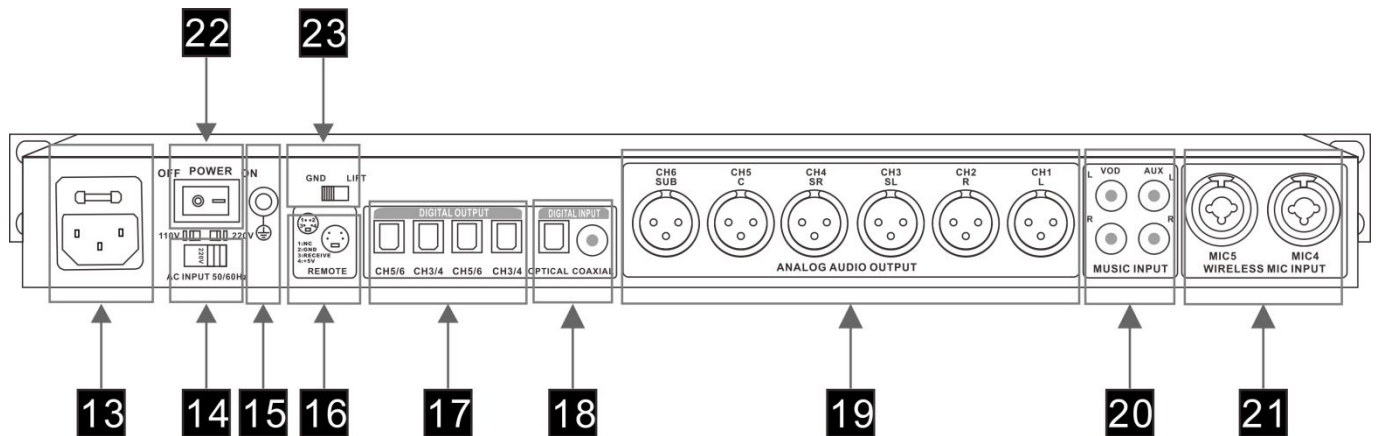

### 13 Exchanging current input socket

Inserting the relative AC input voltage ,according to the shift indicator of power transfer switch

### 14 Power transfer switch

Choosing the relative input voltage gear (110 V/220 V)

Warning: be sure to select the input according to the ac input voltage (110 v / 220 v) voltage gear, such as the wrong choice will may damage the device

### 15 Ground Strobe gating

Control the Turn on /Turn off communication between Chassis and Signal ground.

### 16 Remote control

Can instead of remote control to realize the remote control functions, also can realize the unified system control through conneting Central console.

### 17 Optical Outputs

Four groups of eight digital output channels, identified as CH5 / CH6, CH5 / Ch6, CH3 / CH4, CH1 / CH2.

### 18 Music Digital Inputs

Optical fiber and coaxial input, with analog input , choose one in four.

### 19 Analog Outputs

6 channels output, Marked as L (left Main),R(Right Main),SL (Left Surround ), SR (right Surround ),C (central),SUB (Subwoofer ),Standard 5.1 Channel output.

### 20 Music Analog Inputs

2 set of analog input, identified as VOD, AUX, can be manually selected, can also be smart. Optional gain 0 db and 6 db.

### 21 Mic Input

Rear have two microphone sockets , marked as MIC4、 MIC5, the priority lower than Front Panel's .3 Video Inputs and 1 Output. And for 3 Optional/Automatic Video Inputs, Marked as BGM、 VOD、 AUX, have association with Music input.

## 22 Power switch

Connect the input voltage labeled by power transfer switch, and click the switch to work well.

## 23 Earth wire strobe switch

The connection and disconnection of the cabinet earth and signal earth by the control of this switch .

## 24 Fuse socket: It can be removed from the AC power input socket. The installation diagram of its internal fuse is as follows

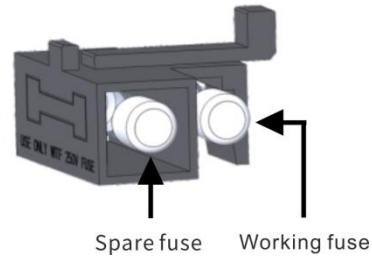

## Remote Controller

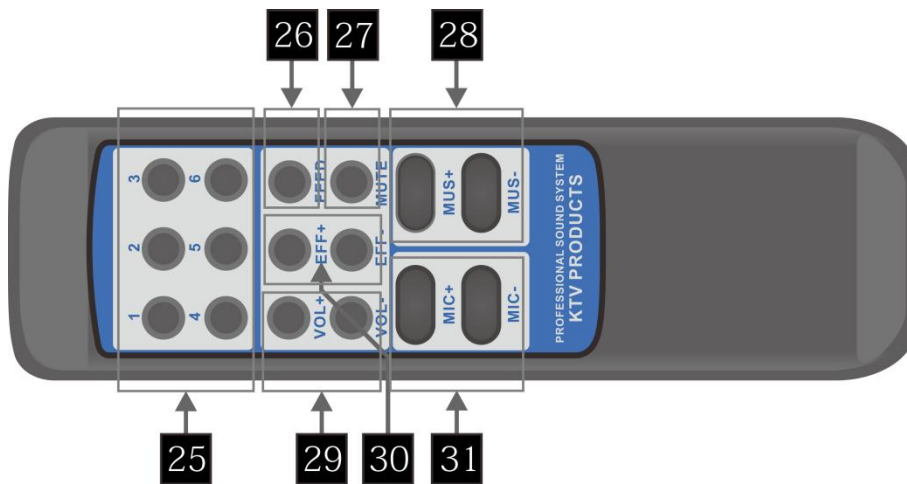

## 25 Fixed effect calls

6 effect fixed modes , marked as 24 (6 keys), Silk screen printing mark 1,2,3,4,5,6 respectively user data 1, user data 2, user data 3, user data 4, user data 5 and user data 6;

## 26 Feedback Switch

Feedback switch can closed or select levels, marked as 25

## 27 Mute Switch

Mute/Unmute Switch of output Channel. Marked as 26 ;

## 28 Music volume

Music volume adjusting keys, Marked as 27 (Two keys)

## 29 Master Volume

Master volume control keys , marked as 28(Two keys)

## 30 Effect volume

Effect volume control keys , marked as 29(Two keys)

## 31 Microphone volume

Microphone volume control keys , marked as 30(Two keys)